

LAW OFFICE
RUTHANN P. LACEY, P.C.

Concentrating in Elder and Special Needs Law

3541-E Habersham at Northlake
Tucker, Georgia 30084

Telephone: (770) 939-4616 • Facsimile: (770) 939-1758

www.elderlaw-lacey.com

**Map and Directions to 3541 Habersham at Northlake
Building E**

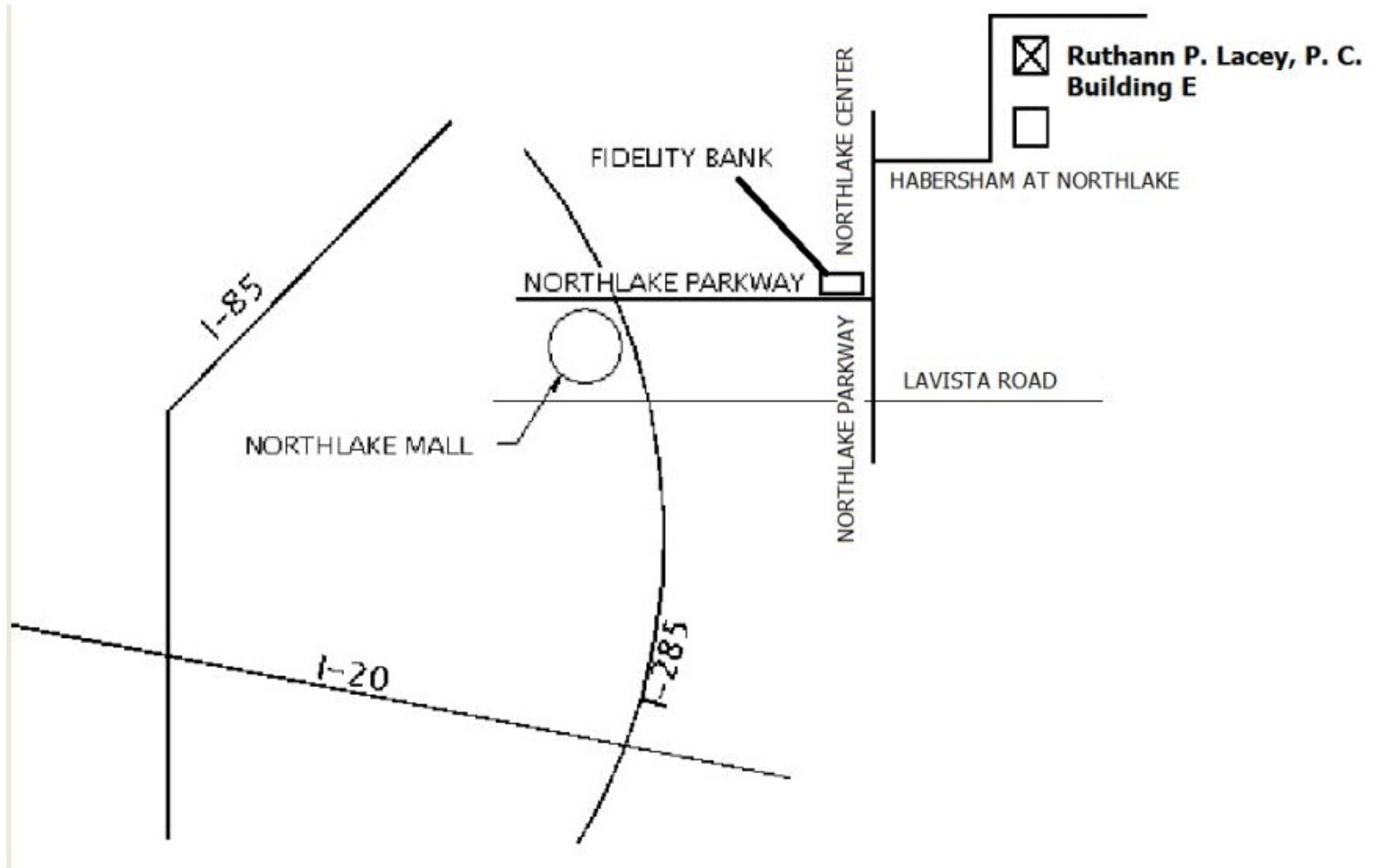

Written directions on following page

**Directions to 3541 Habersham at Northlake
Tucker, Georgia
Building E
Telephone: (770) 939-4616**

Traveling Northbound on I-285 (toward Sandy Springs):

- 1) exit at LaVista Road (exit 37)**
- 2) turn right at the top of the exit ramp**
- 3) immediately move to the left turn lane and turn left at the light onto Northlake Parkway**
- 4) move into the right lane and go straight thru the traffic light (onto Northlake Center)**
- 5) turn right into the entrance to Habersham**

Traveling Southbound (also called Eastbound) on I-285 (toward Decatur):

- 1) exit at Northlake Parkway (exit 36)**
- 2) turn left at the top of the exit ramp**
- 3) proceed to the traffic light (Fidelity Bank will be on the corner on your left)**
- 4) turn left onto Northlake Center**
- 5) turn right into the entrance to Habersham**

INSIDE THE OFFICE PARK

(as you are passing the Habersham entrance sign on your left):

- 1) turn left immediately**
- 2) then our building is the second building on your right - Building E**
- 3) you will see 2 marked handicapped spaces on your immediate right (just outside our building)**
- 4) park anywhere and take the side walk between the buildings (directly in front of the handicapped spaces) toward the American flag at the entrance to our office**

WELCOME!